



## SPECIFICATION SHEET

### PRODUCT # GR510-XX-BZ Extended Pen

**Housing:** Aluminum construction to be used with a commercial tree loop (AX2125-BZ) or ground stake (AX100).

**Lens:** Heat resistant Convex Glass Lens is fully sealed with silicon sealant reduces water build-up and puddle on the lens. Flat Tempered Glass.

**Socket:** All Weather Ceramic fixed socket.

**Lamp:** 8W GU10 or MR16 sold separately.

**Gasket:** A thick rubber gasket.

**Wiring:** 3' #18/2 Direct bury landscape lighting wire with UL listed, stripped hub-ready leads for quick installation.

**Mounting:** 1/2 NPT for mounting into an electric box or tree loop Mounting accessory or ground stake.

**Electrical Notes:** A remote 12V transformer is required if used with a 12V MR16. It may be ordered from Elram separately. Voltage range for LED lamps are 9V-17V.

**Hardware:** Hexagonal crew fix to part.

**Warranty:** Limited lifetime Warranty.

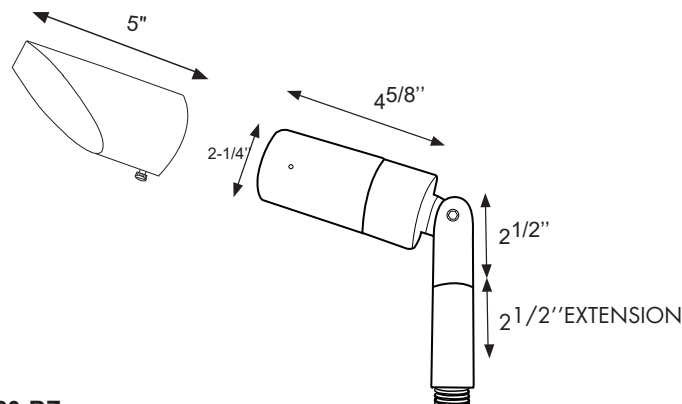

### ORDERING INFORMATION

Sample Part Number: GR510-120-BZ

MOUNT	LIGHT ENGINE	SERIES	VOLTAGE	FINISH	ACCESSORIES	LAMP
<b>GR -</b> 1/2 knuckle w/ABS Stake	<b>blank -</b> LED GU10 or MR16	<b>510 -</b> Extended Pen	<b>blank -</b> 12V  <b>120 -</b> 120V	<b>BZ -</b> Architectural Bronze  <b>WH -</b> White  <b>BK -</b> Black  <b>MS -</b> Matte Silver  <b>GY -</b> Gray  <b>GR -</b> Green	<b>AX142-RD</b> <b>AX515</b> <b>AX2125</b>	
<b>TL -</b> Tree Loop Mounting 2-1/2" Extension included						

AVAILABLE WATERPROOF LED MR16 LAMPS						
LAMP #	BEAM °	CCT	Wattage	Equivalent	Lumen	Rated Hours
L1900	15°	27	4W	20W Halogen	300lm	50,000
L1901	15°	3K	4W	20W Halogen	300lm	50,000
L1902	15°	4K	4W	20W Halogen	300lm	50,000
L1910	45°	27	4W	20W Halogen	300lm	50,000
L1911	45°	3K	4W	20W Halogen	300lm	50,000
L1912	45°	4K	4W	20W Halogen	300lm	50,000
L1915	60°	27	4W	20W Halogen	300lm	50,000
L1916	60°	3K	4W	20W Halogen	300lm	50,000
L1917	60°	4K	4W	20W Halogen	300lm	50,000
L1990	15°	27	7W	50W Halogen	520lm	50,000
L1991	15°	3K	7W	50W Halogen	520lm	50,000
L1992	15°	4K	7W	50W Halogen	520lm	50,000
L2000	45°	27	7W	50W Halogen	520lm	50,000
L2001	45°	3K	7W	50W Halogen	520lm	50,000
L2002	45°	4K	7W	50W Halogen	520lm	50,000
L2005	60°	27	7W	50W Halogen	520lm	50,000
L2006	60°	3K	7W	50W Halogen	520lm	50,000
L2007	60°	4K	7W	50W Halogen	520lm	50,000

**GU10 120V LAMP**  
L3041 39° 3K 8W

### ACCESSORIES

- AX100** ABS stake
- AX515-BZ** 5" Adjustable hood. Fully customizable to the desired size. (Indicate size when ordering)
- AX2125-BZ** Tree Loop Mounting

- AX142-LS** Lens, Linear Spread
- AX142-FR** Lens, Frosted
- AX142-PR** Lens, Prismatic
- AX143-AM** Amber Color filter
- AX143-BL** Blue Color filter
- AX143-GN** Green Color filter
- AX143-RD** Red Color Filter
- AX143-YL** Yellow Color filter
- AX180-BZ** Splice Box
- AX203** Waterproof Wire-nut

